

2nd floor

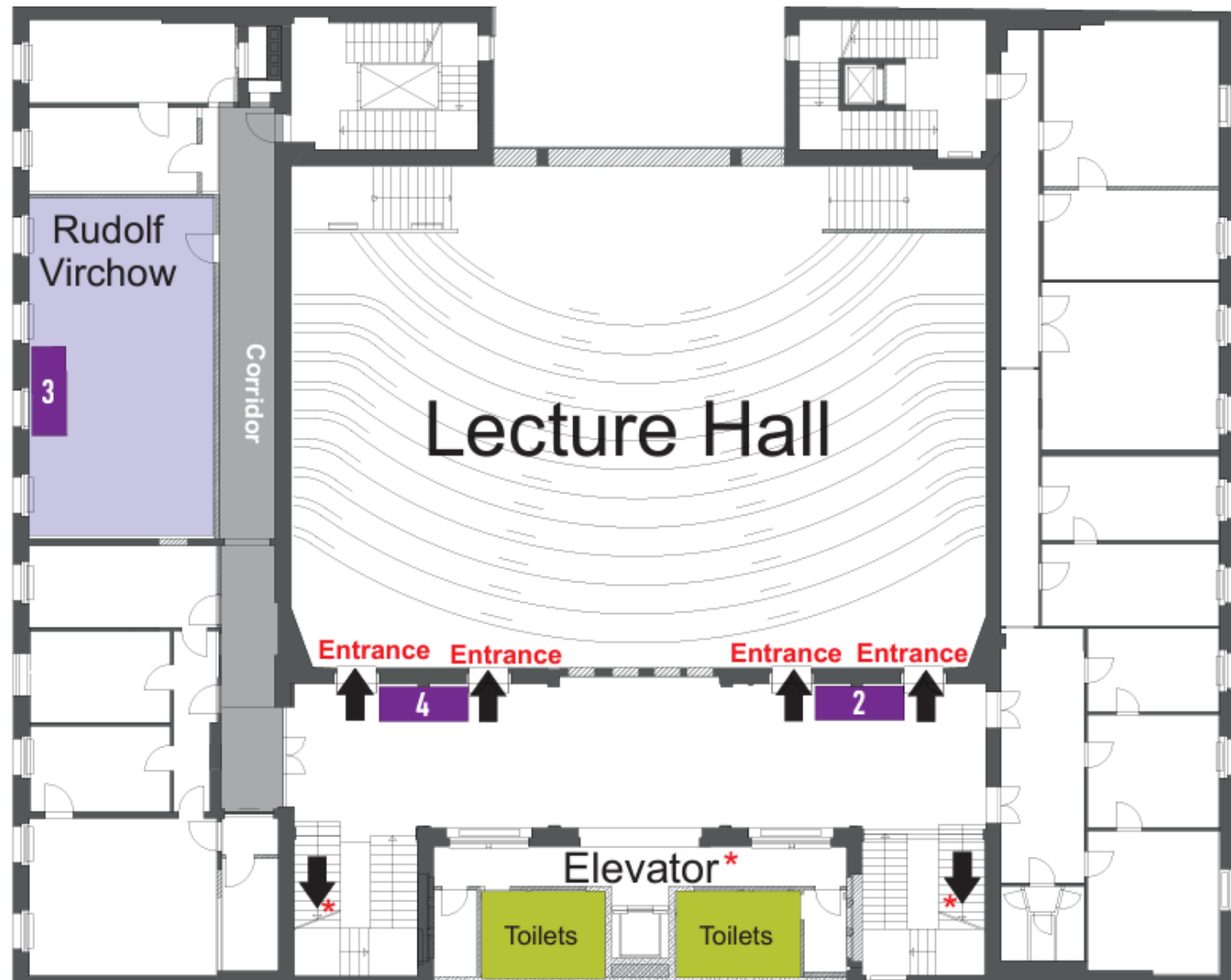

- * The 3rd, 4th and 5th floor can best be reached by elevator, but by stairs as well. The entrance to the gallery of the lecture hall is on the **3rd floor**. ePoster station 5 and the room Paul Ehrlich (resting/quiet room) can be found on the **4th floor**. The Education Day (12th September) takes place on the **5th floor**.